



Spur Reduction Gearhead - 35Nm

Design

Gearhead GBM contains robust steel gear wheels. The spur/helical gears rotate on fixed steel spindles which are hardened and polished to a mirror finish.. The thick output shaft rotates in robust sintered bushings. Ball bearing is also possible on request. All the gears are housed between a robust casting. All bearings are permanently lubricated and therefore require no maintenance.

Features

Gearhead GBM contains robust steel gear wheels. The spur/helical gears rotate on fixed steel spindles which are hardened and polished to a mirror finish.. The thick output shaft rotates in robust sintered bushings. Ball bearing is also possible on request. All the gears are permanently lubricated and therefore require no maintenance.

Options

Gearhead GBM contains robust steel gear wheels. The spur/helical gears rotate on fixed steel spindles which are hardened and polished to a mirror finish.. The thick output shaft rotates in robust sintered bushings. Ball bearing is also possible on request. All the gears are permanently lubricated and therefore require no maintenance.

Standard Data

Parameter	Value	Unit
Gear type	Spur/ Helical	-
Gear Torque	15	Ncm
Combination with Mechtex motors	FHP motors, BLDC & brushed DC & Synchronous/ Stepper motors	
Mounting	any position	
Weight	820	g
Axial thrust	400	N
Lateral force	600	N
Radial torque	6	Ncm
Output bearing	Sintered Bronze, Ball Bearing on request	Ø
Output shafts	dia. 9.5 x 29 mm (with a flat), others on request	
Ambient temperature operation	-15...+ 55	°C
Enclosure	40	IP

Technical Data

Parameter	Value	Unit
Shaft type	OS	
D (+0.00 / -0.10)	24.8	
H	9.5	
d (dia)	9.5	
L	29	
I	24.5	
d	8.4	

Transmission Ratios

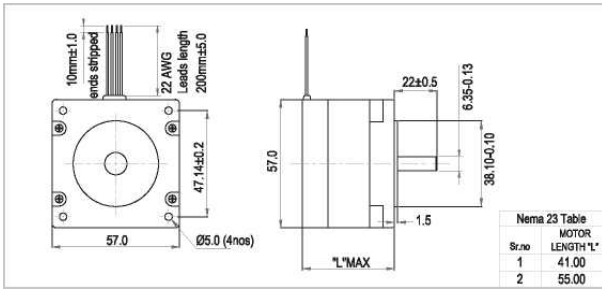

Shaft Drawing

Shaft Drawings

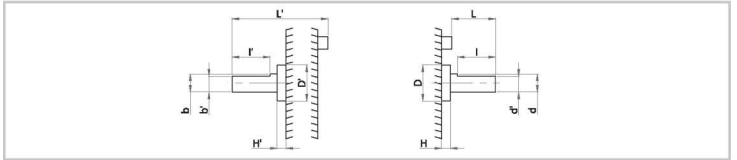

Assembly Drawings

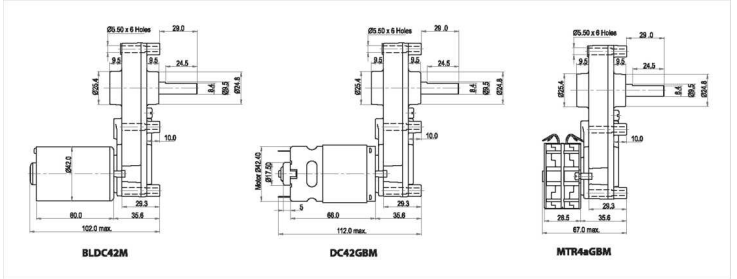

Life Graph

