



GBX



Spur Reduction Gearhead - 30Nm

Design

Gearhead GBX contains heavily loaded steel gear wheels. The spur gears are fixed on steel spindles which are hardened and polished to a mirror finish & rotate in sintered bushings. The thick output shaft rotates in robust bronze bushings. All the gears are housed in between metal plates & closed by plastic dust cover. All bearings are permanently lubricated and therefore require no maintenance. GBX can also be combined with small to medium sizes of DC motors (up to 52mm). Output shaft can also be emerging from the rear side or both sides.

Standard Data

Parameter	Value	Unit
Gear type	Spur	
Gear Torque	30	Nm
Combination with Mechtex motors	MT0, MT6, MTR/S5, MTR/S-4a/b, MTR/SD-4b, MTR/SD4b-RE & DC motors (Up to dia 52 mm) MTR/S 7a & MTR/S 8c	
Mounting	any position	
Weight	850	g
Axial thrust	600	N
Lateral force	900	N
Radial torque	12	Nm
Output bearing	Sintered Bronze sleeve bushings, (Ball bearing on request)	
Output shafts	dia.15 x 26.5 mm (with a flat), others on request	Ø
Ambient temperature operation	-15...+ 55	°C
Enclosure	30	IP

Technical Data

Parameter	Value	Unit
Shaft type	OS	-
D (+0.00/-0.10)	19	
H	6.5	
d (dia)	15	
L	26.5	
I	15	
d	13.5	

Dimensional Drawing

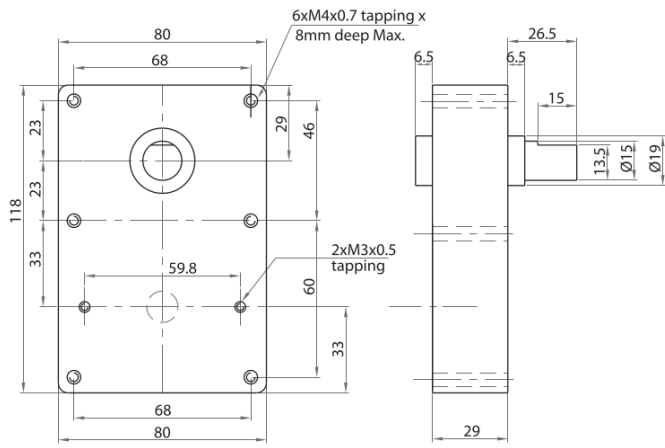

Shaft Drawing

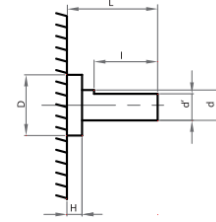

Assembly Drawings

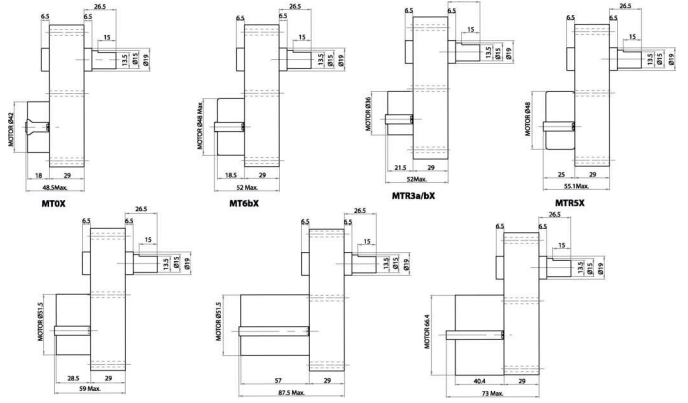

Torque / Life graph

